

STRIKING A MATCH

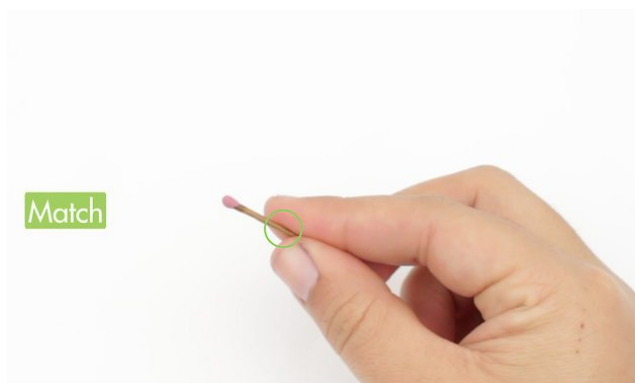

1 Grasp the match firmly at its midpoint.

Use your pointer (index) finger and your thumb to hold the match about halfway down the wooden stick. You can gently wrap your other fingers around the base of the stick for support if needed.

2 Press the match head into the striker.

Look for a rough red or brownish strip on the side of the box. This is called the "striker." Hold the box in the hand you're not using to hold the match and press the match head (the round, coloured part at the end) into the striker without moving it to either side yet.



3 Quickly drag the match head along the striker.

Without letting up the pressure, quickly slide the match head from one end of the striker to the other. This motion should be quite quick and hard. It's almost as if you're trying to rub the match head material off in a single rough motion. If you do this right, the match head will immediately catch fire, so don't be alarmed when this happens!

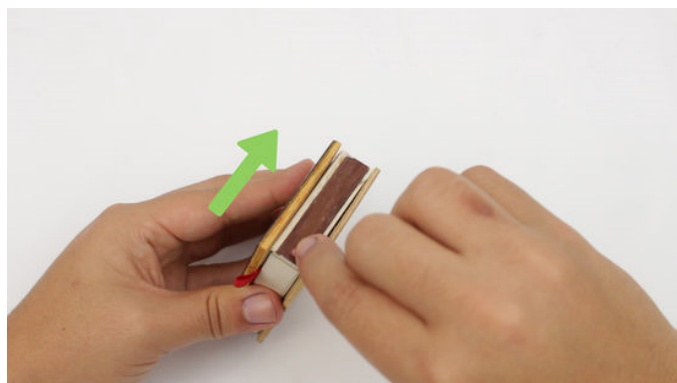

4 Hold the lit match away from the matchbook. You will know as soon as you light your match successfully. It will smoke and burst into flame almost instantly. At this point, grip the match near its base to protect your fingers from the flame and use the match to do whatever you need to do. Set the matchbook aside somewhere safe so that you don't accidentally catch it on fire. Congratulations — you've just lit your first match!